



DUROCK®



Cement Board



Tub surround



Wall shield

Strength beneath the surface™

Strong, durable and resistant to water damage, Durock® Cement Board is ideal for use in partitions, walls, floors and ceilings in residential construction.

Water, Mold and Moisture Resistant.
Durock does not deteriorate in the presence of water making it highly durable in high moisture areas found in baths, showers and kitchens.

Finishing Flexibility.
Durock surfaces are designed for tile setting materials with a smooth side for mastic applications and a rough side for mortar applications.

Superior Strength.
Durock's high compressive strength offers damage and impact resistance while maintaining dimensional stability.

Fire Resistance.
Durock is a non-combustible panel and meets the ASTM standard E136.

30 Warranty.
30-year limited warranty.

For detailed instructions on installation, please see over.

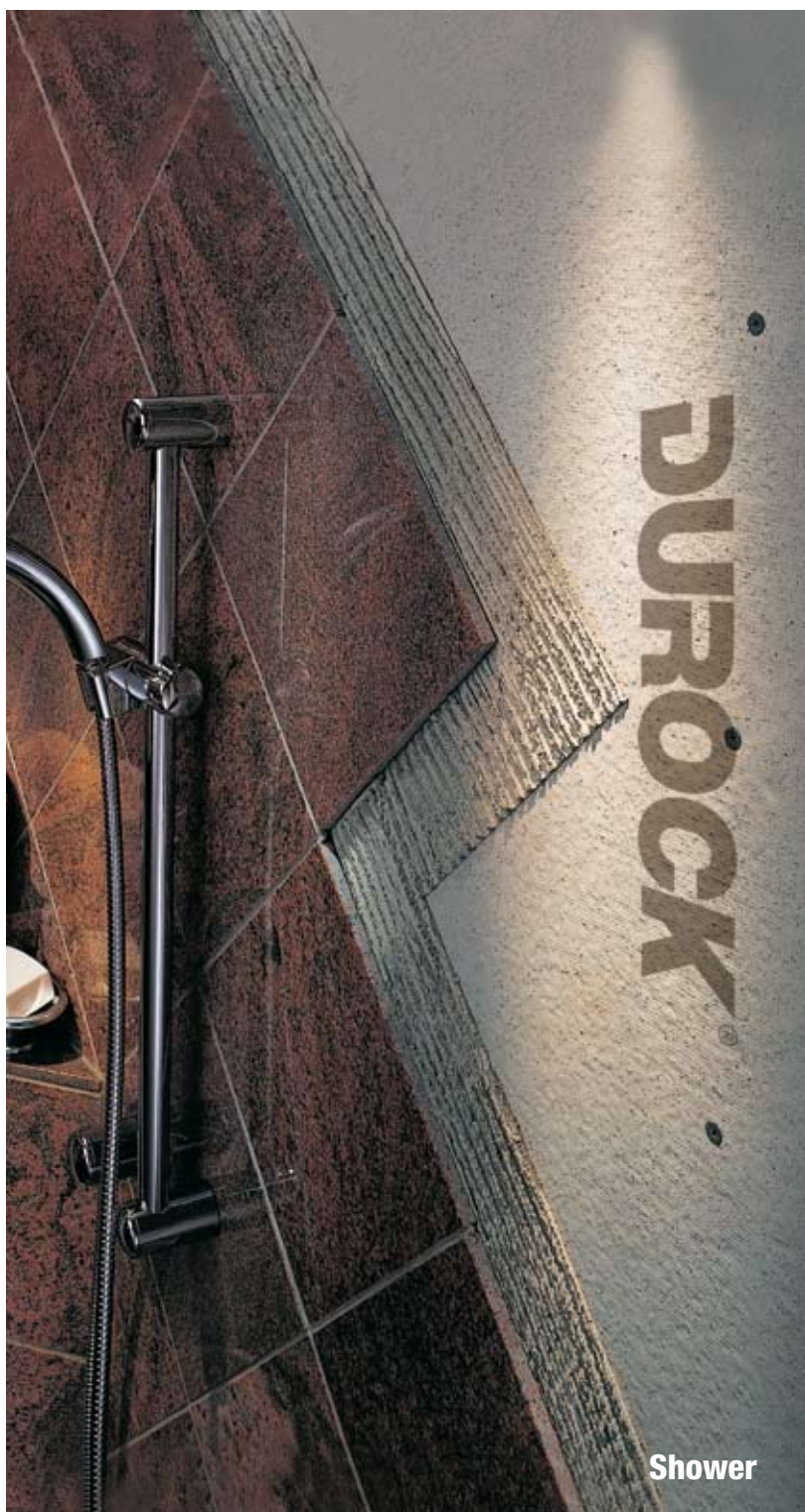

Shower

DUROCK®

Cement Board

Installation Guide

TOOLS AND MATERIALS

- Drill and bits (including hole-saw bits)
- Durock Cement Board Tape (alkali-resistant glass fiber tape)
- Hammer
- Tape measure
- Dust mask/Safety glasses
- Scoring tool
- T-square
- Utility knife
- Durock Wood Screws or hot-dipped galvanized roofing nails
- Wood rasp

CEMENT BOARD INSTALLATION

Walls and Ceilings

Durock Cement Board is smooth on one side for adhesive applications, textured on the other for thin-set mortar applications.

Cutting

To cut Durock Cement Board, measure the desired size on the board and mark on the front and back with a pencil. Score the marks with a utility knife, cut through the glass-fiber mesh then snap the board to size. Smooth

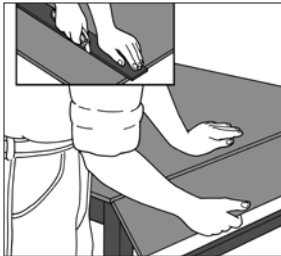

edges with wood rasp. Wear a dust mask and eye protection. Cutting with a circular saw equipped with a carbide-tipped blade is an alternative.

Cutouts

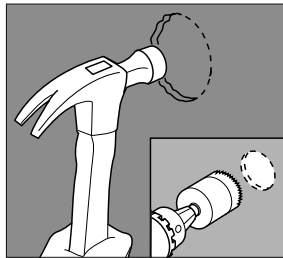

To make cutouts for fixtures, outline area with a utility knife, cut through the mesh on both sides and punch out with a hammer from the back side. Alternatively, mark location and drill hole using the appropriate size hole-saw bit and drill. Smooth edges with rasp.

Attachments



Place a 6 mm (1/4") spacer strip or shim above the lip of tub or shower pan to hold bottom edge of cement board off lip. Fasten board to wood studs spaced at 400 mm

(16") o.c. with 38 mm (1-1/2") hot-dipped galvanized roofing nails spaced 200 mm (8") o.c. for walls, 150 mm (6") o.c. for ceilings, or using 32 mm (1-1/4") Durock Wood Screws with the same spacing. (For steel stud² applications, use 32 mm (1-1/4") Durock Steel Screws). Leave a maximum of 3 mm (1/8") gap between all panel edges.

¹O.C.: On centre or the spacing between the centrelines of two structural members or fasteners.

²Steel studs must be minimum 0.9 mm (20 ga.) thick.

Floors

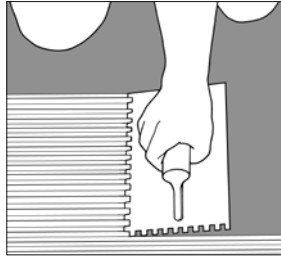

Lamination

Laminate 12.7 mm (1/2") Durock Panel to minimum 16 mm (5/8") thick exterior-grade plywood/OSB using adhesive or mortar suitable for bonding cement backer board to plywood. Apply adhesive with 16 mm (5/8") V-notched trowel or mortar with 6 mm (1/4") square-notched trowel. Laminate and secure one panel at a time. Cover the adhesive with the board immediately.

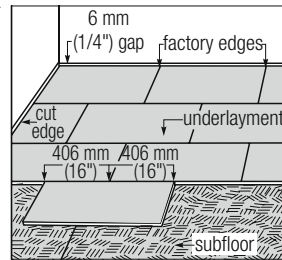

Fasteners

Place panels with joints staggered from subfloor joints. Fit ends and edges closely but not forced together, leaving a maximum 3 mm (1/8") gap. Fasten panels to subfloor while the adhesive is wet with 38 mm (1-1/2") hot-dipped galvanized roofing nails or 32 mm (1-1/4") Durock Wood Screws spaced 200 mm (8") o.c. in both directions. When 16 mm (5/8") Durock Cement Board is used in underlayment applications, follow the same procedure as for 12.7 mm (1/2") cement board.

Wall Shields

Cut 1/2 Durock Brand Cement Board to panel and furring strip sizes with carbide-tip scoring tool.

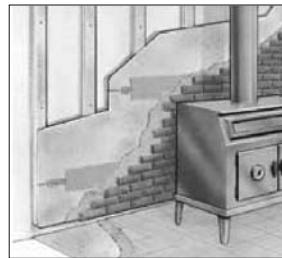

Smooth rough edges with wood rasp. Fasten furring strips to framing with 38 mm (1-1/2") hot-dipped galvanized roofing nails spaced 200 mm (8") o.c. Fasten wall shield through furring to framing with 70 mm (2-3/4") nails 200 mm (8") o.c. Maintain 19 mm (3/4") minimum framing penetration for both furring and shield.

JOINT TREATMENT Walls, Ceilings, Floors and Countertops

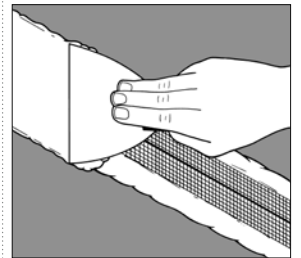

Prefill all joints, as well as outside corners of countertops, with latex-fortified mortar or Type 1 organic adhesive and then immediately embed Durock tape and level joints. Use Durock Cement Board Tape for strongest joints and the best bond.

Durock Cement Board Systems

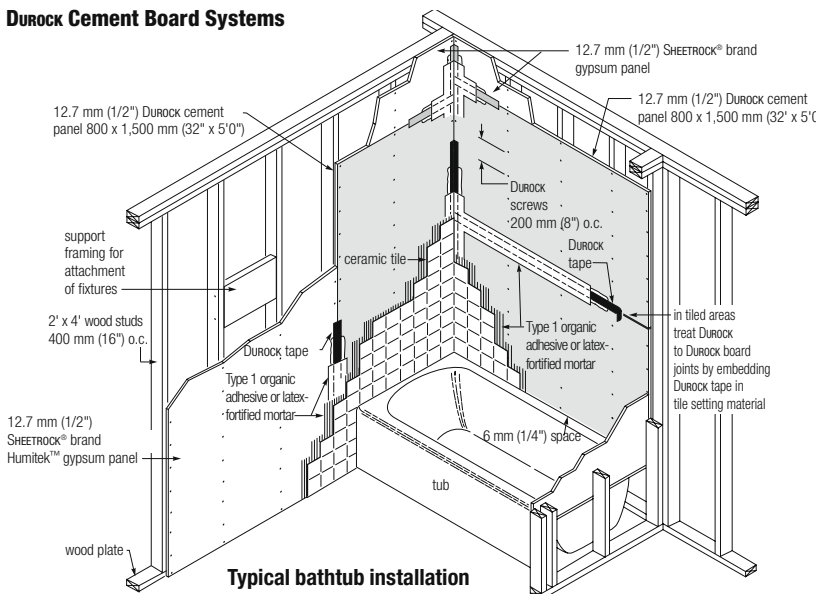

Alternate diagram for Cement Board Installation

Typically you can use two 900 x 1,500 mm (3' x 5') cement boards horizontally for tub backwall, one 900 x 1,800 mm (3' x 6') board vertically at each endwall.

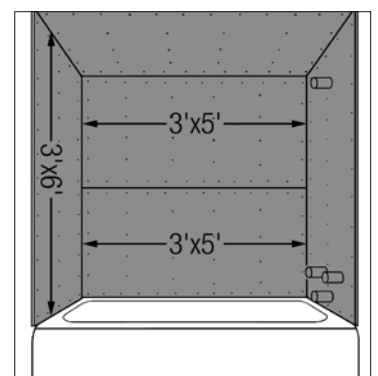

To install 4 Durock panels

12.7 mm x 800 mm x 1,500 mm (1/2" x 32" x 60"), you need:

1 Durock installation kit



Plus adhesive



Or:

150 fasteners

1 roll of Durock tape

50 mm x 15 m (2" x 50')

946 ml of adhesive